

## SPECIFICATIONS

Frequency Range: 26.4-40.1GHz  
 Relative Bandwidth: 3%  
 Insertion Loss (dB Max): 0.3  
 Isolation (dB Min): 20  
 VSWR(Max): 1.2  
 Load Power (W): 500(10%)  
 Connector Type: WR28

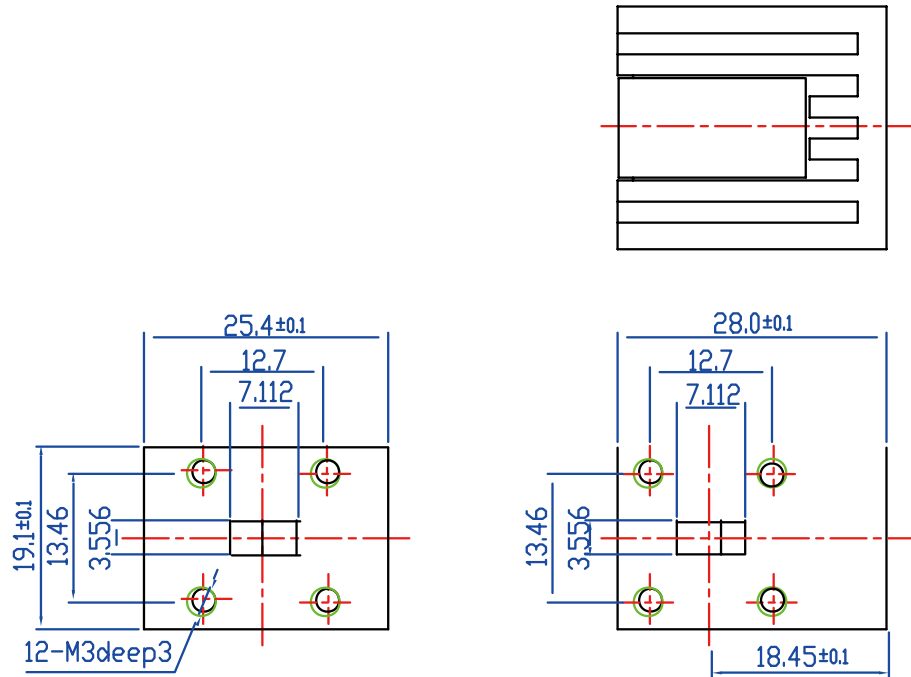

**OCEAN MICROWAVE CORPORATION**

OCEAN MICROWAVE CORPORATION  
 25# Building Advanced Business Park 18 zone Fengtai  
 Fengtai district Beijing China  
 Tel: +86-10-60290088 | Fax: +86-10-63497801  
<http://www.ecmicrowave.com>

DESCRIPTION:

High Power Series ( Isolator )

MODEL NO. :

BH320-25.4B1

DIMENSIONS ARE  
 IN MILLEMETERS  
 DECIMAL  
 TOLERANCE:

SIZE:

CAGE  
CODE:

REV CODE:

SCALE: N / A

ALL SPECIFICATIONS ARE SUBJECT  
 TO CHANGE WITHOUT NOTICE AT  
 ANY TIME

SHEET 1 OF 1